

Qubo

A **Hero**
Group Venture

The QBOOK

Qubo Dashcam GPS N



Product Introduction

A smart video camera for your car to record events happening on the road.

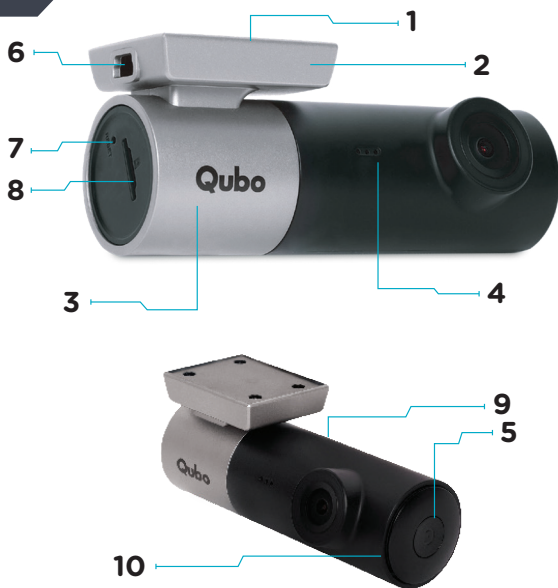

- | | | |
|--------------------|---------------------|--------------------------|
| 1. Adhesive Pad | 2. Mounting Bracket | 3. Rotating Shift |
| 4. Mic | 5. ON/OFF | 6. Mini USB Port |
| 7. Reboot Key | 8. SD Card Slot | 9. Speaker (at the back) |
| 10. LED (Blue/Red) | | |

Product Specifications & Packaging Contents

Model number	:	HCA02
Resolution	:	1920x 1080P
Extended Storage	:	MicroSD card, upto 256 GB, Class10 or above
Wi-Fi	:	IEEE 802.11 b/g/n 2.4GHz
Battery Capacity	:	240 mAh Lithium ion Battery

Contents

1. Dashcam GPS with Double-Sided Adhesive Tape
2. Hardwiring Kit
3. Additional Double-Sided Adhesive
4. Installation Pry Tool

Installation Process

Ideal mount area

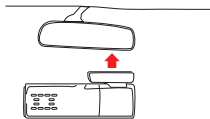
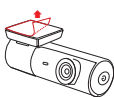

1. Charge the Dashcam for 3 hours before Installation. You can use your mobile charger to charge the same.
2. Clean the Windshield area where the Dashcam is to be installed.
3. Remove the Protective Film from the Double Sided Adhesive and attach it on the windshield such that the view of the Driver is not blocked and proper view of the Front in correct orientation is present.
4. Attach the Hardwiring Kit with the Dashcam and with the help of Installation Tool/Pry tool you can tuck In the Cable properly by lifting the Windshield/ molding.

Installation

Step 1 Locate and Connect the fuse box

Most vehicles have a fuse box underneath the dashboard of driver's or passenger's side.

Select a suitable car fuse box based on the wiring path and the location of the main device, and connect it to the Hardwiring Kit.

Please ensure that the fuse box can contain the followings:

1. Regular electric fuse with an output voltage of 12/24V and max output current of 2A;

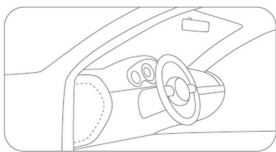

2. ACC power fuse.

Step 2 Connect the Hardwiring Kit to the fuse box

Connect the wires of the Hardwiring Kit to the fuse box in the following way:

1. Connect the Negative GND cable (Black) to the regular electric fuse with an output voltage of 12/24V and output current of 1 A inside the fuse box;
2. Connect the ACC signal cable (Yellow) to the ACC power fuse inside the fuse box;
3. Connect the ground wire (Red) to the negative terminal or ground of the fuse box.

Important notes:

- The actual installation and wiring path of the Hardwiring Kit may differ from the illustrations in the manual. Please seek assistance from a professional technician.
- Before installation and wiring, please turn off the car engine and power to prevent short circuit.
- Please do check to use only the non-essential equipment's fuse like radio, electric window, sunroofs, air conditioner, cigarette lighter, loudspeaker etc and not the essentials like fuel pumps, wipers, engines etc.

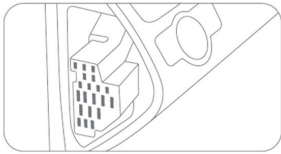

Step 3 Connection with Dash cam

Connect the USB Mini-B port of the Hardwiring Kit to the power outlet of the main device (DC/IN). Start the engine and wait for the dashcam to turn on.

Step 4 Cable management

Route the Hardwiring Kit to the location of the main device. Tuck the cable into the headliner, run the cable from the headliner down to the fuse box alongside the A-pillar. If the Hardwiring Kit is too long, tie it up, but do not cut it. Cutting the Hardwiring Kit will affect the power and ACC signal to the main device.

6. Turn on the Car Ignition and check if the Dashcam gets a Red LED Indication. Device then announces that “Qubo Dashcam is ready for Setup.” Download the App and follow further steps from the App.

Note: We recommend to first install the dashcam and then mount it on the Windshield for your convenience.

App Download Instructions

Step 1.

Search for QuboPro on the Google Play Store and App Store or you can **Scan the below QR Code to download the App-**



App Link - <https://bit.ly/3Pjsl2n>

Step 2.

Install Qubo Pro App

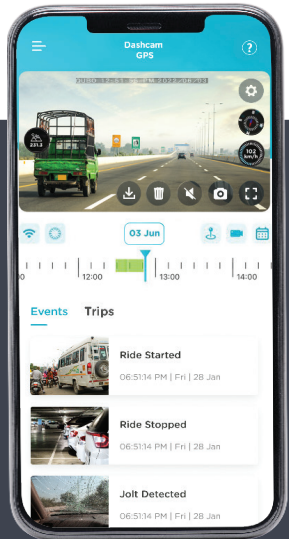

To Connect the Dashcam with the App

Open the App and Choose the Dashcam. Then App will automatically search for available Wi-Fi Hotspots. Choose the one of the Dashcam. It will get auto connected from there. If required, enter the details for the same as follows-

Default Wi-Fi Name : Qubo_DashCAM_XXXXXXX

Default Password : 12345678

(Note: During the Installation of the device you will be asked to change your Default Device Wi-Fi Name and Password. Please do so for your device security.)

App Screen Attributes



Settings Screen

Attributes

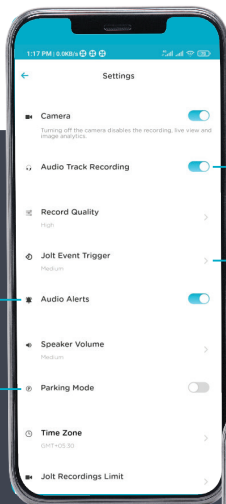

To enable/
disable audio
alerts and
sound from
Dashcam

To enable/
disable parking
mode (works
with Hardwiring
Kit only)

SD Card
Storage
occupied

Details about
the Device

Option to enable/
disable audio track
recordings

Sensitivity of the Jolts

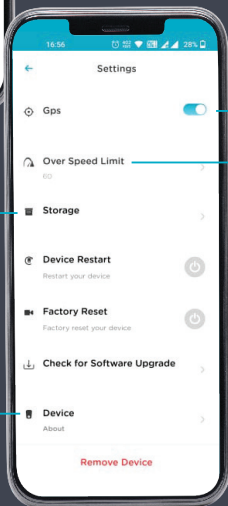

To enable/
disable
GPS Mode

To enable/
disable
and set the
Over Speed
limit for
alerts

Recording Access Options

CONTINUOUS RECORDING

To access all the captured recordings, please use the Timeline Bar (Marked in red). The color of the timeline bar will be Blue (ignition off) - To show stored recordings in parking mode Green (ignition on) - To show live recordings in driving mode.

EVENT BASED

The Dashcam creates specific Event based recordings and they can be accessed from the Events tab.

TRIP BASED

The Dashcam also creates recordings based on Trip and they can be accessed from the Trips tab.

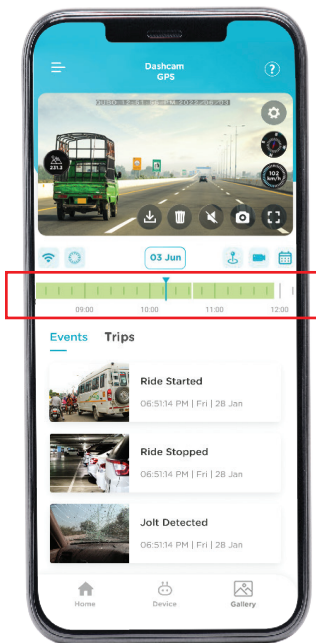

LED Indications and Key Functions

Situation	LED Behavior
Power On	Blue
Commission Starts	Red Blinks
Commission Success	Steady Blue for 5 seconds and off
If commission not initiated from mobile for long time	Red Blinks
Commission Failed	Steady Red
Factory Reset	Blue Blink
Format SD Card	Blue Blink
If user not at all inserted SD card	Steady Red
After power ON, start the recording	Steady Blue

REBOOT KEY

This key reboots the device. Please reboot the device if the Device hangs or functions abnormally.

Button Functionality

BUTTON - POWER BUTTON

Function	Action
Turn the Dashcam On	Press Once
Turn the Dashcam Off	Press Twice
Factory Reset	Long Press & Hold for 10 sec till the LED stops blinking
SD Card Format	If the SD Card is unsupported then a voice prompt is received from Device. Then Press Once to Format SD Card

Hardwiring Kit Product Specifications & Package Contents

Input voltage: DC 12-30V

Max Output voltage: DC 5V

Max Output current: 2.4A

Low voltage protection for small cars: 11.9-11.6 V

Low voltage protection for heavy vehicles: 23.9-23.6 V

Product Introduction

As an accessory to Qubo Dashcam, this product must be used with the main device. After correctly installed and connected with the main device, Hardwiring Kit will power and transmit ACC signals to the main device, and provide low-voltage protection to prevent over-discharging of the car battery due to the continuous operation of the main device.

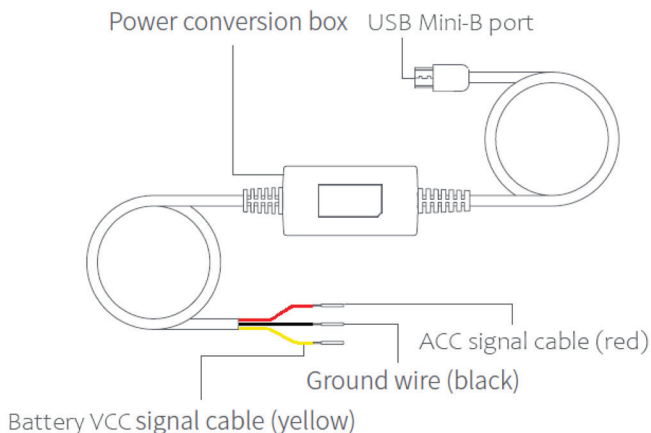

Additional Events in Parking Mode

Event	Details
Shut Down-High Cabin Temp	When the Cabin Temperature reaches the maximum permissible level the Device will auto Shut Down and will re-start once the Car Engine is Turned On
Shut Down-Low Car Battery	When the Car Battery reaches the minimum threshold set, the Device will auto Shut Down and will re-start once the Car Engine is Turned On
Jolt Detected P	Jolt Events during Parking Mode

Note :

1. For Parking Mode to function you need a hardwiring Kit. Also you need to enable Parking Mode from Settings option

Safety

Precautions

1. Qubo Smart Dashcam Pro N records videos of outside moving vehicles. It can't protect drivers and passengers from any accidents. We shall not take any responsibility if the user gets involved in any traffic accident and/or bear any loss due to product failure, information loss, or product operation.
2. Due to differences in vehicle type, driving preferences, the environment, and other differences, parts of the product or the whole product may not work normally in some circumstances. The device may not record normally due to loss of power source, abnormal temperatures and/or humidity, collisions, damage to the Micro SD card, and other reasons. We do not guarantee that all the recorded videos will be saved completely in any given situation. The images recorded by this product are for reference only.
3. Install the product correctly. Do not block the driver's vision. Do not obstruct the air bag. Keep the product at least 20cm away from the driver and passengers. Incorrect installation of the product may cause product failure and injury.
4. Keep this product away from strong magnetic fields to avoid damage.
5. Do not insert or pull out the Micro SD card when the product is working to avoid damaging the Micro SD card.
6. Use a Micro SD card with storage capacity between 16GB and 256GB, and reading and writing speed not lower than Class10. Format the Micro SD card before using it.
7. Micro SD card may be damaged after repetitive use. Replace Micro SD cards in time to maintain proper recording.
We shall not bear any responsibility caused by failed Micro SD cards.
8. The product can record and save footage of traffic accidents, but we do not guarantee all accident footage can be recorded and saved.
9. Do not use this product in temperatures higher than 65° C or lower than -5° C.
10. Do not shake or press the product. Strong impact or shaking may cause irreparable damage to the product.

11. Do not clean this product by chemical solvents or cleansers.
12. Use this product within the scope of the law.
13. Avoid chemical cleansers and solvent that can damage plastic components. You should clean the camera lens regularly to improve the quality of recorded video. Wipe the lens with a non-scratch lens cloth, optionally dampened with isopropyl alcohol. Allow the lens to air dry.

Troubleshooting

My camera feels warm while it is operating.

It is normal for the camera to feel warm during typical use, especially while it is recording high-resolution video or transmitting a Wi-Fi signal.

My memory card has degraded and needs to be replaced

All micro SD memory cards wear out after they are overwritten a large number of times. Periodically formatting the card can extend the useful life and improve performance. Because the Qubo Dashcam Pro N records continuously, you may need to replace the memory card periodically. Your device detects memory card errors automatically and alerts you when it is time to format or replace your memory card.

You can take these actions to help extend the useful life of the memory card.

- Format the memory card at least one time every six months
- If the device displays a memory card error alert, first try formatting the memory card and then, if necessary, replace the memory card
- Turn off the device when your vehicle is not in use
- If your device is not connected to an ignition- switched vehicle power outlet, you should turn off the device when your vehicle is not in use to prevent the Qubo Dashcam Pro N from recording unneeded footage. Transfer saved video footage to a computer. The memory card lasts longer when more free space is available on the card
- Use a memory card with a higher storage capacity
- Because higher-capacity memory cards are overwritten less frequently, they usually last longer

- Use a high-quality memory card with a speed rating of class 10 or higher
- Purchase your replacement memory card from a high-quality manufacturer and a reputable vendor

My video recordings are blurry

- Clean the camera lens
- Clean the windshield in front of the camera
- Verify the area of the windshield in front of the camera is cleared by the windshield wipers, and move the device, if necessary

My video recordings are choppy or incomplete

- For the best camera and video results, use a high- quality memory card with a speed rating of class 10 or higher. A slower memory card may not record video quickly enough
- If you are viewing videos on your smartphone using a wireless connection to the camera, try viewing them in another location with less wireless interference, or try transferring videos to the smartphone
- Transfer important recordings to a computer or smartphone, and format the memory card
- If the device displays a memory card error alert, first try formatting the memory card and then, if necessary, replace the memory card
- Update your device to the latest software

My Dashcam does not connect with the App when my phone is connected with Wireless Apple Car Play/ Android Auto

Wireless Apple Car Play/ Android Auto also connect to your phone through a wifi hotspot. Hence, please disconnect them temporarily while connecting your phone to dashcam to set up or view/ download videos from the dashcam. Please note that your dashcam records when the car's ignition is on even if your phone is not connected to the dashcam.



**For more queries,
please scan the QR Code**

LIMITED WARRANTY

Statement

Thank you for selecting the Qubo Dashcam Pro N by Hero Electronix.

NOTE : This is a simplified and concatenated version of the standard warranty terms and conditions. For the complete warranty terms and conditions, please refer to the website link given at the end of the document. Alternatively, you can reach out to our toll free helpline number to know about the same.

IMPORTANT : Please retain your receipt as proof of purchase.

HERO Electronix Private Limited warrants to the owner of the Qubo Dashcam Pro N, (henceforth referred as Device) that the Device will be free of defects in material and workmanship for a period as mentioned below.

Item	Warranty Period	Scope of Warranty
Device	1 year from the date of Purchase	This warranty covers only the defects in products arising from manufacturing or faulty workmanship.
Car Charger / Cables	6 months from the date of Purchase	
Hardwiring Kit (If Applicable)	6 months from the date of Purchase	
RTC Battery	6 months from the date of Purchase	

During this warranty period, if any defect arises in the Device, HERO Electronix will, at its sole discretion, either

(i) repair the device free of cost with either new or refurbished parts, or
(ii) replace the Device with a new or refurbished Device that is equivalent to the Device to be replaced. This limited warranty applies to any repair, replacement part or replacement device for the remainder of the original warranty period or for 90 (Ninety) days, whichever period is longer.

This limited warranty is non-transferable.
This limited warranty is only valid in India.

Instructions

For specific instructions about how to obtain warranty services for your Device, please contact our toll-free helpline. In general, you will need to deliver the Device in either its original packing or in equally protective packing to the address specified by Customer Service. HERO Electronix will bear all the cost of the return shipping to the owner except with respect to any Ineligible Product (defined below), for which owner will have to bear all the cost.

THIS LIMITED WARRANTY DOES NOT COVER THE FOLLOWING (COLLECTIVELY INELIGIBLE PRODUCTS)

- (i) If the warranty seal on the Device is broken.
- (ii) Devices that have been subjected to: (a) modifications, alterations, tampering or improper maintenance and repair (b) handling, storage, installation, testing or use not in accordance with any User guide, Placement guidelines, other instructions provided by HERO Electronix (c) abuse or misuse of the product. (d) breakdown, fluctuations, or interruptions in electrical power or the telecommunication network; or (e) Acts of God, including but not limited to lighting, flood, tornado, earthquake or hurricane.
- (iii) errors and damages caused by: (a) liquid ingress, or spilled food, or physical abuse, or normal wear and tear, (b) use of or being connected to any accessory which was not supplied or authorised by HERO Electronix.
- (iv) Plastic components like front or back covers plus rubber components.
- (v) Physical or cosmetic damage to Silicon cover

CORRECT DISPOSAL OF THE PRODUCT



In case you need to dispose of this device at any time in the future, please contact our toll-free helpline. To facilitate effective utilisation of resources, we will arrange the disposal of this device as per the prevailing laws. Please note that electrical products should not be disposed of with household waste.

FOR ALL PRODUCT RELATED COMPLAINTS/ASSISTANCE, PLEASE CONTACT

Hero Electronix Pvt. Ltd. 503, 5th Floor Rectangle 1,
D4, Saket District Center, New Delhi - 110017

Email us at: support@quboworld.com | 1800-572-5757
www.quboworld.com